

## Coding Instructions For A Replacement RFID Reader

The Replacement RFID Reader's memory is blank or empty. In order to code your daily use FOB's Or Wristbands, you must first enroll a 'Master Code' into the Replacement RFID Reader's memory. Please follow the instructions below carefully.

### Enrolling the 'Master Code'

1. Hold the Activation Tool or the Red Wristband next to the ID Sensor
2. It will sound a double beep.
3. To verify the new 'Master Code', wait 10-seconds and place the new Activation Tool or Red Wristband next to the ID Sensor.
4. If a double beep is sounded, the Replacement RFID Reader has accepted the new 'Master Code'.
5. The code is now embedded and can NOT be removed. The reader is now ready to enroll all of the other electronic keys assigned to the truck.

### Enrolling Additional Codes

1. Hold the Activation Tool or Red Wristband next to the ID Sensor/Antenna
2. It will sound a double beep, click for 10-15 seconds and then sound a solid tone for 10-seconds.  
As soon as the 10-second solid tone starts, remove the Activation Tool or Red Wristband and place the Random FOB or Black Wristband next to the ID Sensor.
3. When the double beep sounds, remove the Random FOB or Black Wristband.
4. To verify the new code, wait 10-seconds and place the new Random FOB or Black Wristband next to the ID Sensor.
5. If a double beep sounds, the Replacement RFID Reader has accepted the new code.
6. Repeat steps 1 through 5 to enroll all codes that are required for the operation of the truck.

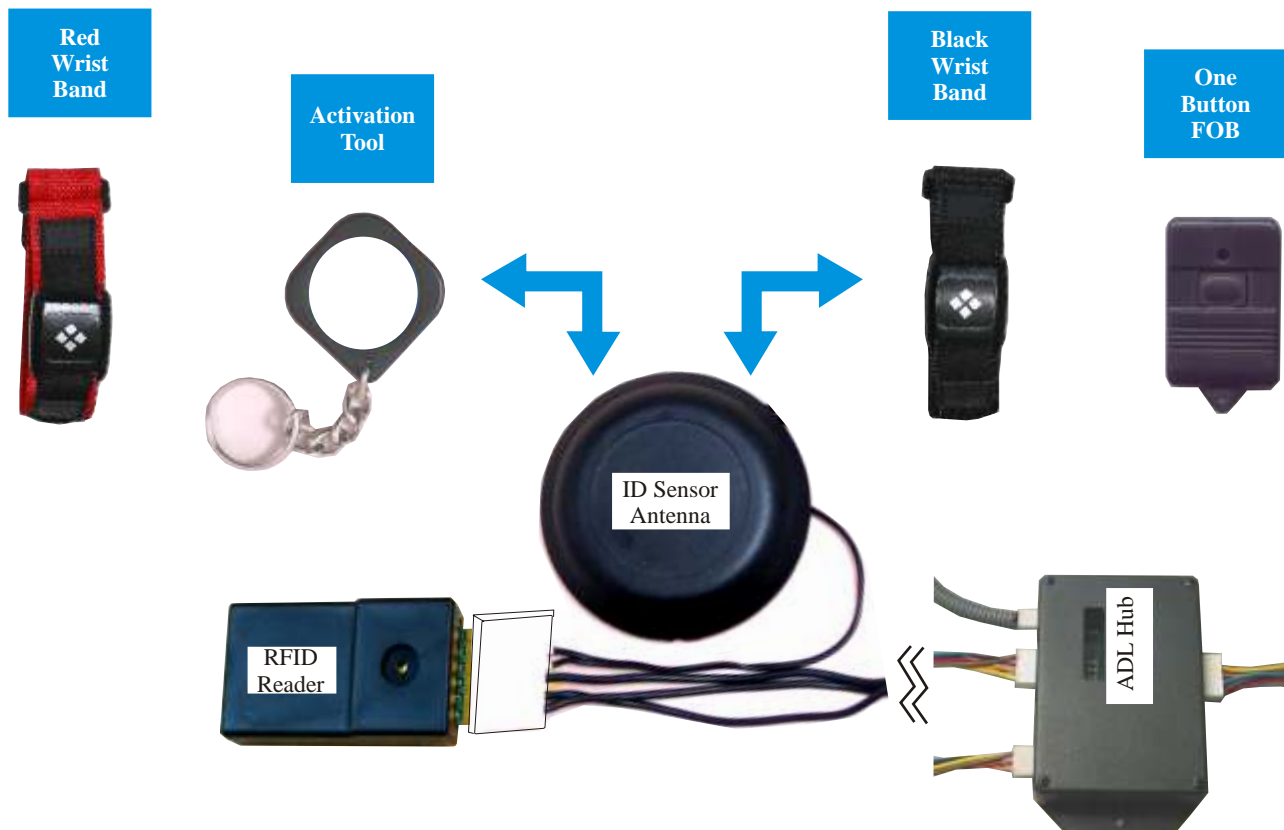

# Coding Instructions For A Replacement RFID Reader

## Definitions

### Activation Tool

A dual-purpose tool used to program 'Uncoded' RFID Readers installed in USPS trucks.



### Black Wristband

A key with an 'unknown' code for daily use of a specific Fed Ex Ground truck.



### Red Wristband

A tool used to program 'uncoded' RFID Readers installed in Fed Ex Ground trucks.



### Delivery Location Fob

A 'Master' key fob coded for a specific VMF, capable of unlocking doors and activating The ignition system of all vehicles assigned to that VMF.



### Random Truck Fob

A key fob with an 'unknown' code for daily use of a specific USPS truck.



### ID Sensor

A round antenna mounted on the instrument panel or on the side of a truck.



### RFID Reader

The modules, which receive the unique code from a Red or Black Wristband, a Delivery Location Fob, a Random Truck Fob or an Activation Tool. The signal is accepted and then resent to the ADL Hub.

